



**BUILDING SITE BESIDE
23 DRENNAN ROAD, LISBURN, BT27 6UT**

- An Excellent Building Site Situated Within This Highly Desirable And Most Convenient Location
- Outline Planning Permission Granted For Detached Dwelling And Garage
- Planning Portal Reference LA05/2021/0464/O Decision Dated 13 November 2024
- Site Area Extends To Approximately 0.4 Acre (If required, the site can be Increased slightly, by negotiation)
- Pleasant Rural Aspects Over Fields And Open Countryside To Side And Front
- The location is perfect for those seeking country living and convenience for commuting to work and schools
- Convenient to Lisburn M1 motorway (only 4.5 miles) Hillsborough, Sprucefield, Temple, Carryduff and South Belfast

Directions: From Lisburn proceed along Saintfield Road and into Old Ballynahinch Road towards Ballynahinch, after 4.2 miles turn left into Drennan Road, the site is 0.3 mile on the left beside number 23

PRICE: OFFERS IN THE REGION OF £125,000

VIEWING BY APPOINTMENT THROUGH AGENTS

ENERGY EFFICIENCY RATING n/a

REF:DL170125HG

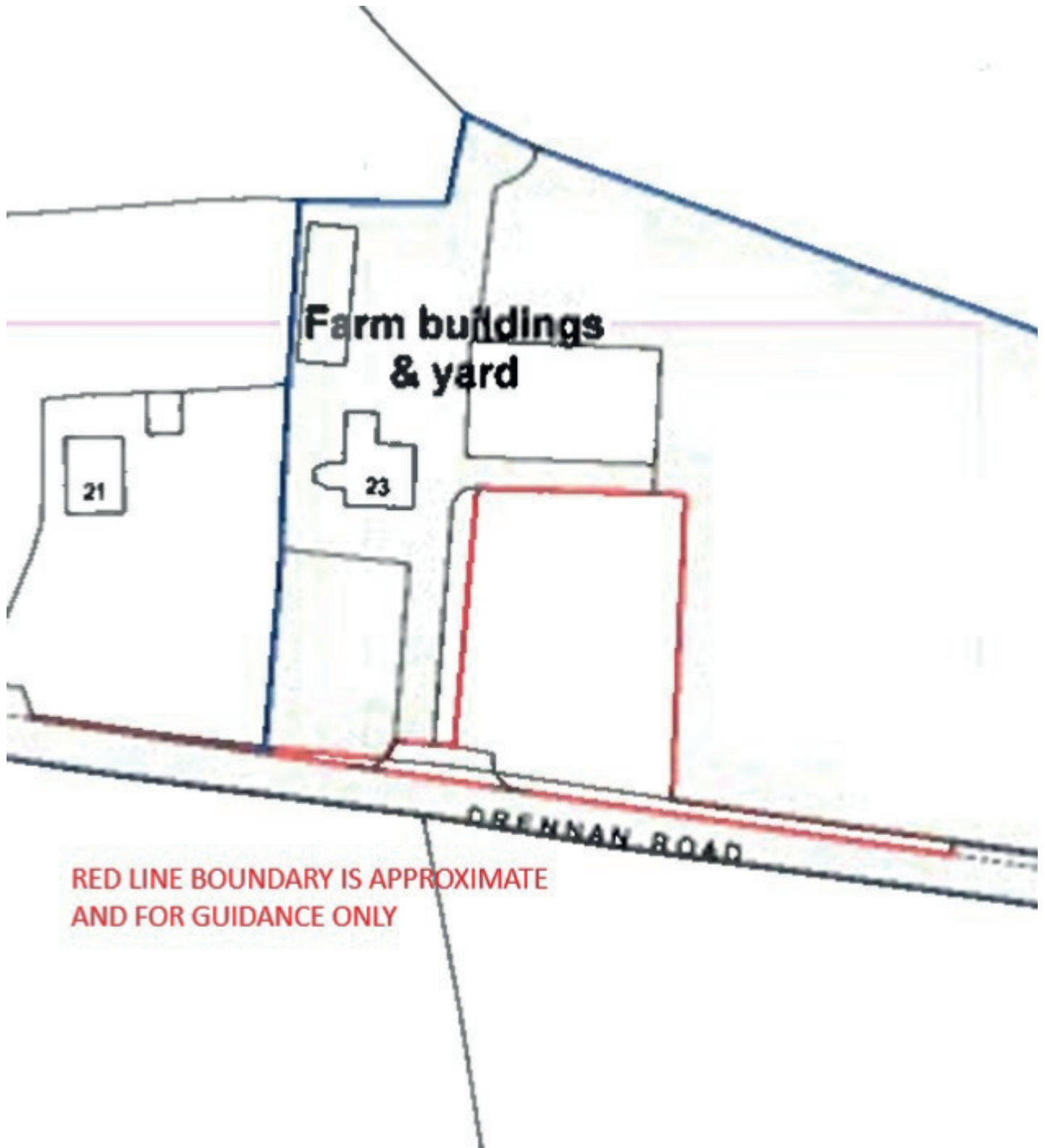



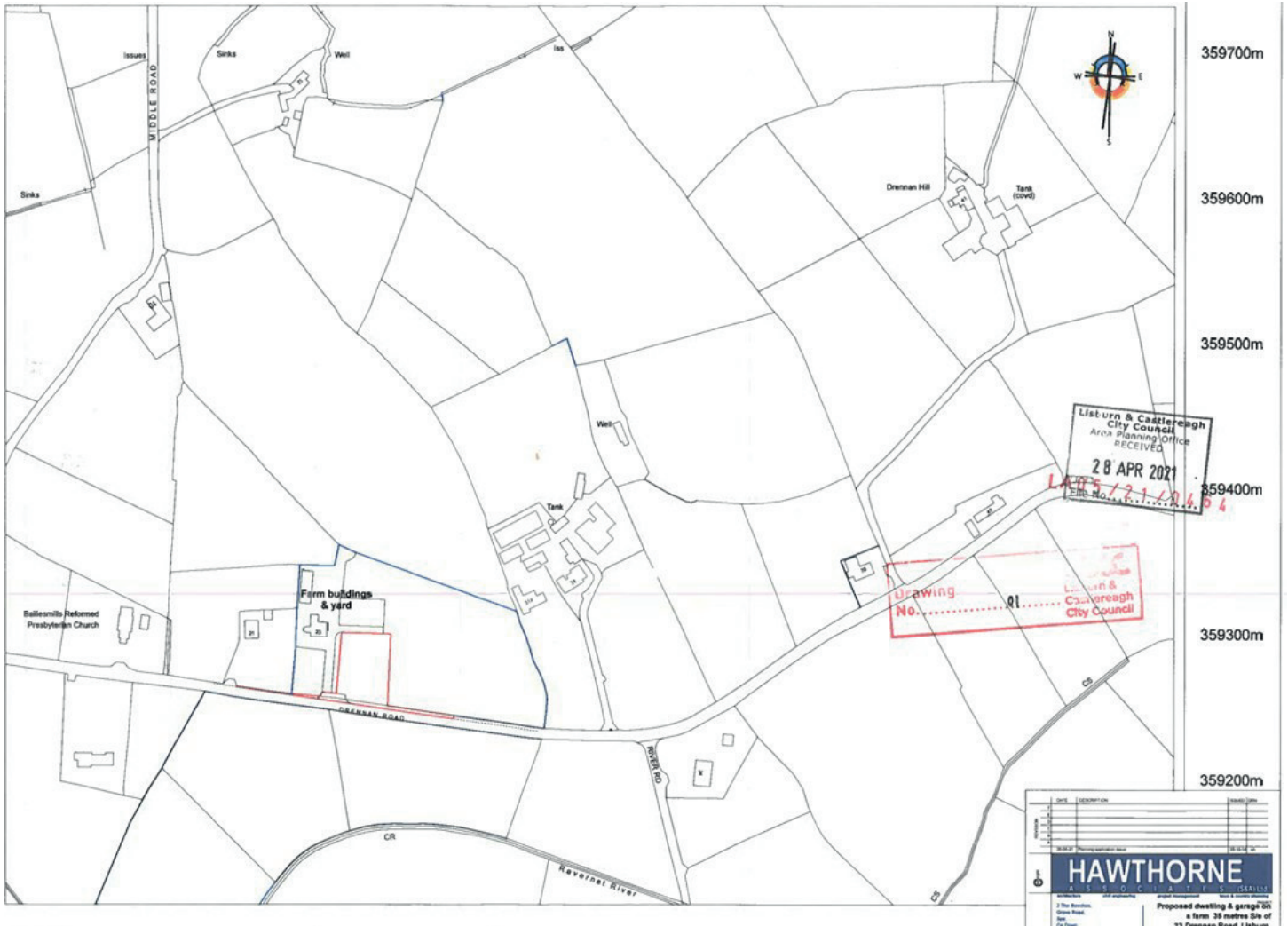

VALUATION SERVICE

We can arrange a **FREE** pre sale valuation of your property at a time to suit you.

www.hgraham.co.uk

58-60 Bachelors Walk, Lisburn, Co. Antrim BT28 1XN T: 028 9267 2929 E: info@hgraham.co.uk

The above details do not constitute any part of an offer or contract. None of the statements contained in this sales brochure is to be relied on as statements or representations of fact and any intending purchaser must satisfy himself by inspection or otherwise as to their correctness. Neither the vendor, nor Henry Graham Estate Agents, nor any person employed in the company has any authority to make or give any representation or warranty whatsoever in relation to this property. All dimensions are approximate and are taken at widest points.